



		MODEL 5660	MODEL 5691
		Compatible with Dehumidifier Models 1820, 1830 & 1850	Compatible with Dehumidifier Model 1870
A	Width	18"	27"
B	Inside Rail Width	6 ¹⁵ / ₁₆ "	10 ¹ / ₂ "
C	Outside Rail Width	9 ¹⁵ / ₁₆ "	13 ¹ / ₂ "
D	Length	29 ⁷ / ₈ "	35"

SPECIFICATIONS		
Model	5660 Hanging Kit	5691 Hanging Kit
Dimensions: (Hanging Kit Only)		
Width	18"	27"
Height	6 ¹⁵ / ₁₆ "	6 ¹⁵ / ₁₆ "
Length	29 ⁷ / ₈ "	35"
Weight	13 lbs.	18 lbs.
Weight: (Working Load)	400 lbs.	400 lbs.
Shipping Weight: (w/Carton)	14.6 lbs.	19.7 lbs.

▶ **MODEL 5660/5691 DEHUMIDIFIER HANGING KIT**

- + 14 gauge zinc-plated steel
- + 1/4" thick black neoprene pads for vibration insulation
- + 10' cables with Gripple® clamps and 3 1/2" bolts
- + Total safe working load 400 lbs.
- + Parts bag includes (4) 3/8" flat washers, (4) 3/8" hex nuts, and Gripple key

Installing an Aprilaire Dehumidifier with Model 5660 and 5691 Hanging Kits

- 1 Open box and remove the contents.
Contents include:

- + Hanging bracket with cables and bolts
- + 8 nuts, 8 washers
- + Gripper key
- + Installation instructions



- 2 Unfold the hanging bracket so the support bars are perpendicular to the hanging bars.



- 3 Use two washers and two nuts on each cable bolt when mounting the hanging bracket to a structure. Make sure the structure can support the weight of the hanging bracket and dehumidifier.



- 4 Extend the dehumidifier feet approximately 3/4" to 1".



- 5 With the feet extended, center the dehumidifier on the hanging bracket, with the feet outside of the support bars.



- 6 Adjust the height of the hanging bracket by either pulling on the cable or inserting the Gripper key to release tension.

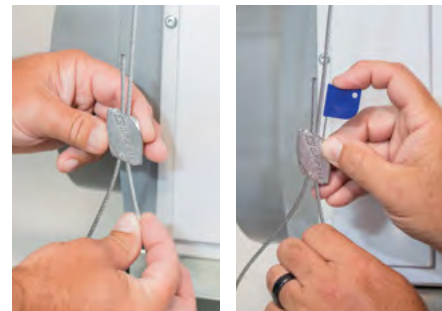

CAUTION:
BRACKET AND DEHUMIDIFIER
MUST BE SUPPORTED WHEN KEY
IS USED TO RELEASE THE CABLE.

- 7 Set a level on top of the dehumidifier to make sure it is level in both directions.

